

SPECIFICATION

LED PANEL LIGHT

ITEM NO.: HL-PSI33-L6P360MC

CUSTOMER

Checked by	Approved by

SUPPLIER

Drawn by	Approved by



HOUSE LIGHTING CO.,LTD.

Tel:+86-755-28402263

Fax:+86-755-28402268

Web:www.led-house-lighting.com

E-mail:sales@led-house-lighting.com

1. Features of the Products

- * Ultra thin, only 12mm.
- * Very attractive appearance and special design of LED Edge-Lit technology.
- * With Isolated Driver, designed and produced by ourselves: 110-270VAC.
- * Life-span:50000 hours.
- * No flickering or buzzing and RF Interference.
- * With CE, ROHS, FCC Approval.
- * 300*300, 300*600, 300*1200, 600*600, 600*1200mm LED panel lights are available.

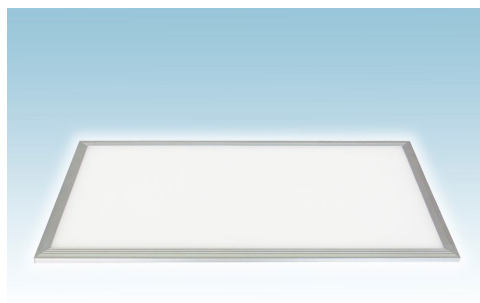

2. Application area

- * Factories & Offices.
- * Hospitals & Hotels.
- * Schools, Colleges & Universities.
- * Conference / Meeting rooms.
- * Commercial Complexes, Shopping mall and living room.
- * Meets the general and decoration lighting

3. Parameter

Dimension: 300mm * 600mm*12mm	Power: 36W
Input Voltage: AC110-270V	Luminous flux: 3000±5%lm
LED Efficiency: 85lm/W±5%	CRI: 75±5Ra
LED quantity: 360pcs	LED Type: 3014 SMD
Power Efficiency: ≥0.92	Power Factor: >0.93
Shell Material: PMMA + Aluminum	Beam Angle: 120°
Correlated Color: Cool white	
Color Temperature: 6000-7000k	
Operating Temperature: -5°F to 122°F (-20°C to 50°C)	

4. Spectrogram

Light Source Test Report

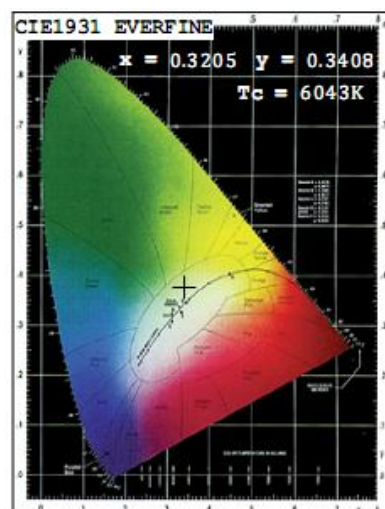
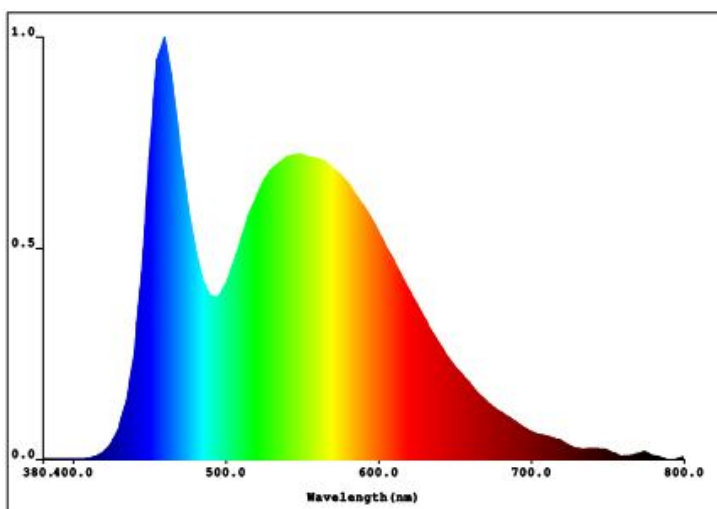

Color Parameters:

Chromaticity Coordinate: $x=0.3205$ $y=0.3408$ $u=0.2170$ $v=0.3356$

$T_c = 6043K$ Dominant WL: $\lambda_d = 534.2nm$ Purity=8.7%

Red Ratio: $R=11.5\%$ Peak WL: $\lambda_p = 459.5nm$ HWL: $\Delta\lambda_d = 33.6nm$

Render Index: $R_a = 74.8$

$R_1 = 66$ $R_2 = 11$ $R_3 = 16$ $R_4 = 61$ $R_5 = 66$ $R_6 = 61$ $R_7 = 11$

$R_8 = 60$ $R_9 = -61$ $R_{10} = 66$ $R_{11} = 62$ $R_{12} = 36$ $R_{13} = 51$ $R_{14} = 92$ $R_{15} = 59$

Photo Parameters:

Flux: 2997lm Eff = 82.97lm/W Pe: 4985mW

Electrical Parameters:

$U = 220.0 V$, $I = 0.1754A$, $P = 36.12 W$, $PF = 0.936$

System State: Integral Time $T = 646.00 ms$ $I_p = 44778 (69\%)$

Model: Z-1000

Tester: JX

Temperature: 25.3deg

Manufacturer: HOUSE LIGHTING

Number: YF-2357

Date: 2011-03-15

Humidity: 65%

Remarks:

5. Outline Dimension

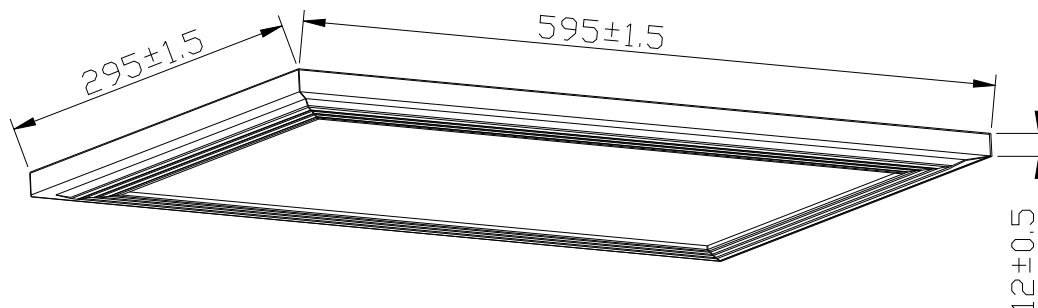

Unit: mm
Design: HOUSE LIGHTING

6. Packing

- * Packing QTY/Carton: 1 pcs
- * GW / PCS: 2.52kg
- * GW / Carton: 3.15kg

Unit: mm
Design: HOUSE LIGHTING

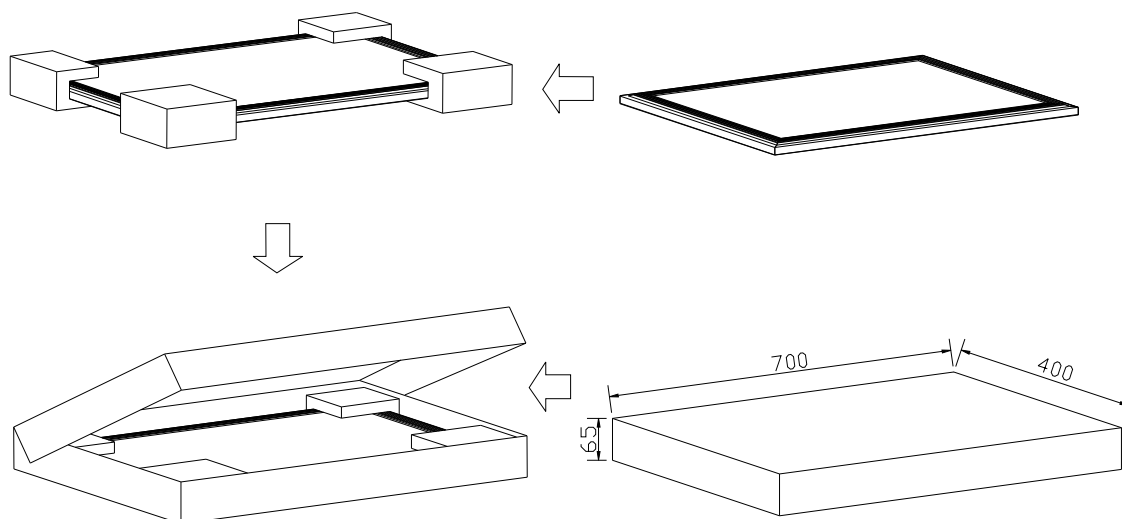

7. Installation

A. Recessed type

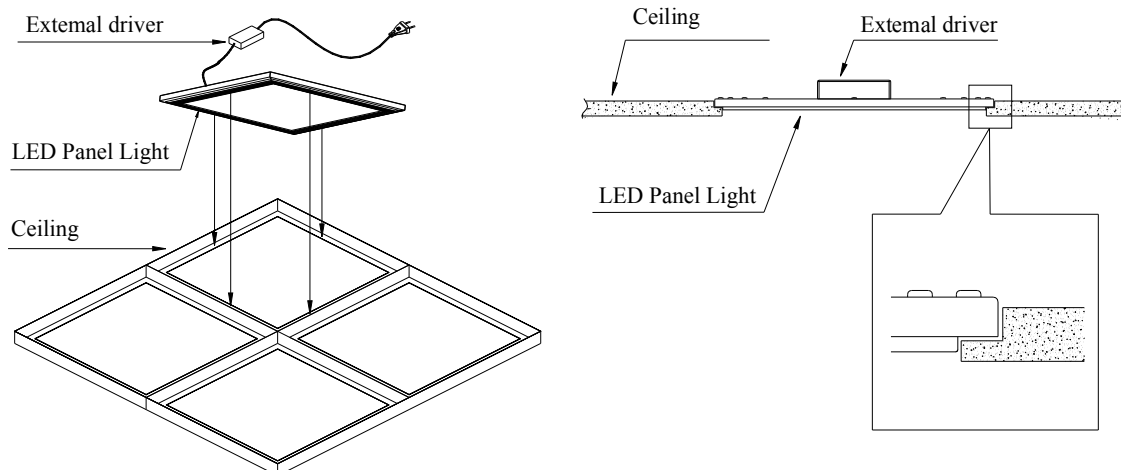

B. Suspended type

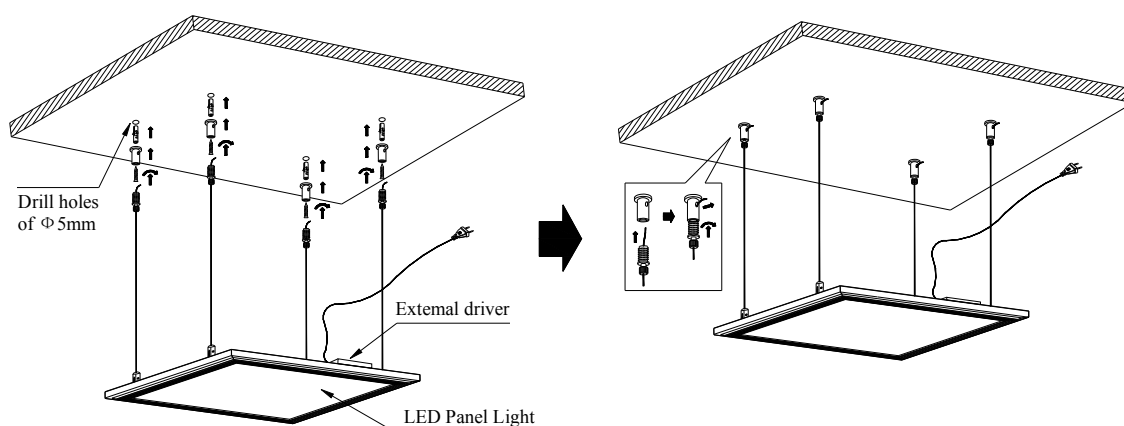

Remarks :

1. Please install the lamp by professionals.
2. Please make sure the right voltage before working.
3. For indoor use only, please stay away from heat and vibration source.
4. Switch OFF the power before installing the LED Panel Light.