

TERMOMIX COMPACT MIXING VALVE DS AND CS

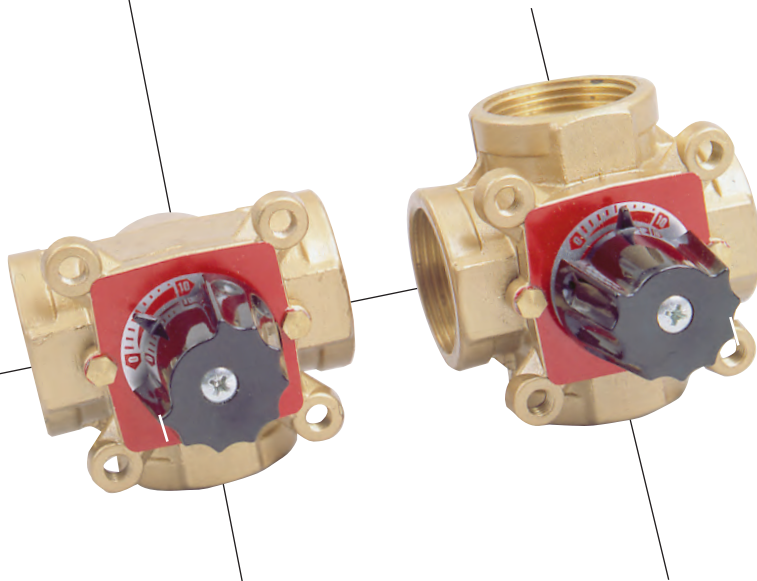

TECHNICAL DATA

Max. operating temperature	110°C
Max. operating pressure	1,0 MPa (10 bar)
Angle of rotation	90°
Torque	0,2 Nm for 3-way valves 0,1 Nm for 4-way valves
Valve body	Brass
Slide	Brass
Cover	Brass
Spindle	Brass
Spindle sealing	Two O-rings, EPDM
Motorizing	Suitable for all valve motors

TERMOMIX 3-way and 4-way compact mixing valves of brass have been developed especially for small hydronic heating systems, boilers, heat exchangers and air heating/cooling applications. TERMOMIX valves can be used as mixing valves or as diverting valves. There are several ways of installing. TERMOMIX valves have excellent control characteristics. They control both supply and return lines. The valves can be mounted in any position. TERMOMIX valves are very suitable for motorizing because of their low torque. The valves are available for right-hand and left-hand mounting.

ORDERING DATA

Order No:	Type:		
3315	TERMOMIX D 15 S	Rp 1/2"	3-way mixing valve
3320-4	TERMOMIX D 20 S	Rp 3/4"	3-way mixing valve
3320-6,3	TERMOMIX D 20 S	Rp 3/4"	3-way mixing valve
3325-8	TERMOMIX D 25 S	Rp 1"	3-way mixing valve
3325-12	TERMOMIX D 25 S	Rp 1"	3-way mixing valve
3332	TERMOMIX D 32 S	Rp 1 1/4"	3-way mixing valve
3415	TERMOMIX C 15 S	Rp 1/2"	4-way mixing valve
3420-4	TERMOMIX C 20 S	Rp 3/4"	4-way mixing valve
3420-6,3	TERMOMIX C 20 S	Rp 3/4"	4-way mixing valve
3425-8	TERMOMIX C 25 S	Rp 1"	4-way mixing valve
3425-12	TERMOMIX C 25 S	Rp 1"	4-way mixing valve
3432	TERMOMIX C 32 S	Rp 1 1/4"	4-way mixing valve

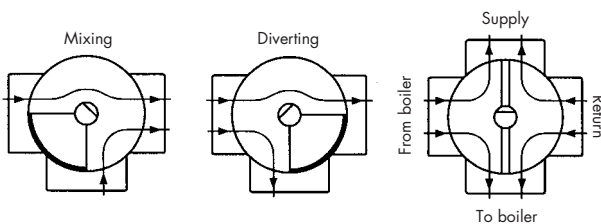

LK ACASO AB
Box 634
SE-521 21 Falköping
Tel: +46 515 107 50
Fax: +46 515 590 30

E-mail: info@lkacaso.se
Internet: www.lkacaso.se



LK Acaso

TERMOMIX COMPACT MIXING VALVES DS AND CS

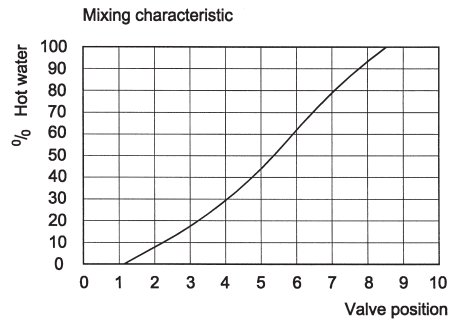
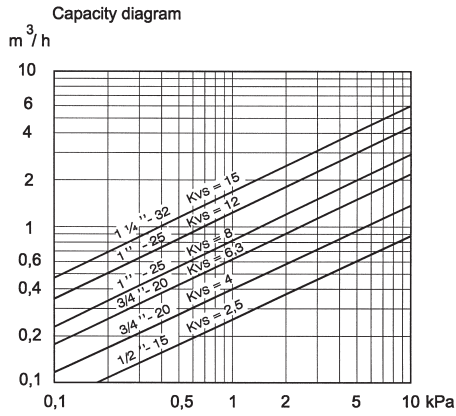

TERMOMIX DS 3-WAY MIXING VALVE

Order No	Type	Kvs	A mm	B mm	C mm	D mm	E mm	Weight kg
3315	D 15 S	2,5	15 - Rp 1/2"	80	21	61	74	0,70
3320-4	D 20 S	4	20 - Rp 3/4"	80	21	61	74	0,70
3320-6,3	D 20 S	6,3	20 - Rp 3/4"	80	21	61	74	0,70
3325-8	D 25 S	8	25 - Rp 1"	82	21	62	75	0,75
3325-12	D 25 S	12	25 - Rp 1"	82	21	62	75	0,75
3332	D 32 S	15	32 - Rp 1 1/4"	84	25	65	75	0,85

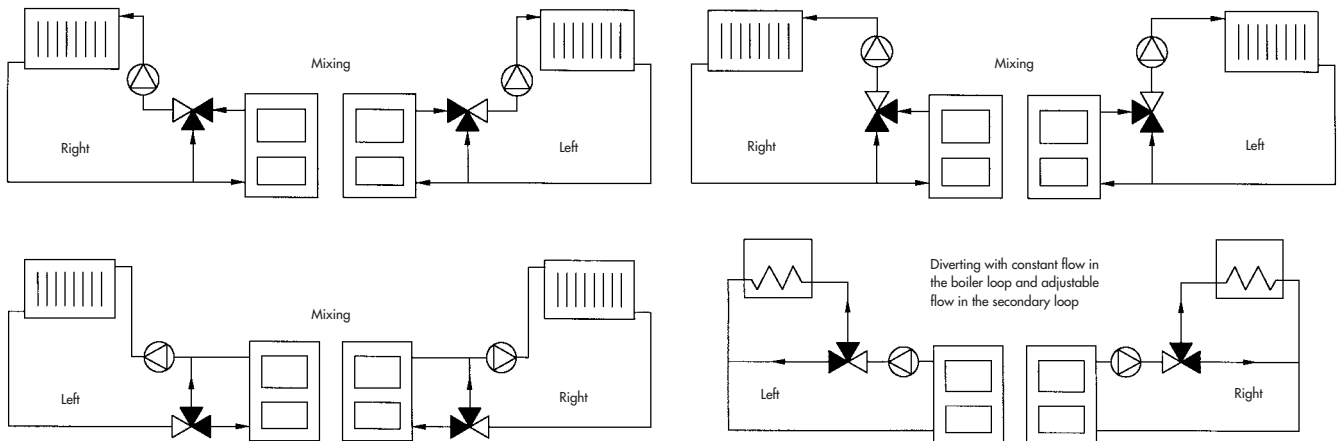
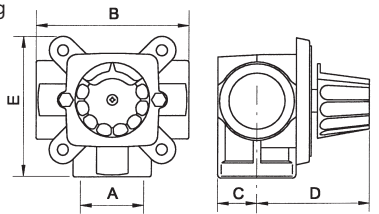

TERMOMIX CS 4-WAY MIXING VALVE

Order No	Type	Kvs	A mm	B mm	C mm	D mm	E mm	Weight kg
3415	C 15 S	2,5	15 - Rp 1/2"	80	21	61	80	0,80
3420-4	C 20 S	4	20 - Rp 3/4"	80	21	61	80	0,80
3420-6,3	C 20 S	6,3	20 - Rp 3/4"	80	21	61	80	0,80
3425-8	C 25 S	8	25 - Rp 1"	82	21	62	82	0,85
3425-12	C 25 S	12	25 - Rp 1"	82	21	62	82	0,85
3432	C 32 S	15	32 - Rp 1 1/4"	84	25	65	84	0,90

